

**THE COUNCIL OF THE BOROUGH OF MILTON KEYNES  
(VARIOUS ROADS, CONNIBURROW)  
(PROHIBITION AND RESTRICTION OF WAITING AND LOADING)  
ORDER 2013**

The Council of the Borough of Milton Keynes ("the Council") in exercise of its powers under sections 1(1), 2(1) and (2), 4(2) and Part IV of Schedule 9 of the Road Traffic Regulation Act 1984 ("the Act") and of all other enabling powers, and after consultation with the chief officer of police in accordance with Part III of Schedule 9 to the Act, hereby makes the following Order:

**PART 1**

**IMPLEMENTATION, CITATION, DEFINITIONS AND REVOCATIONS**

1. This Order shall come into operation on the 25<sup>th</sup> February 2013 and may be cited as "The Council of the Borough of Milton Keynes (Various Roads, Conniburrow) (Prohibition and Restriction of Waiting and Loading) Order 2013".

2. In this Order, except where the context otherwise requires, the following expressions have the meanings respectively assigned to them:-

"access way" means a length of road sufficient to enable a vehicle to have access to and egress from land or premises in or adjacent to the road;

"bus" means a motor vehicle constructed or adapted to carry more than eight passengers (exclusive of driver);

"Civil Enforcement Officer" ("CEO") has the same meaning as in Section 76 of the Traffic Management Act of 2004;

"Council" means The Council of the Borough of Milton Keynes;

"delivering" and "collecting" in relation to any goods includes checking the goods for the purpose of their delivery or collection;

"disabled persons' badge" has the same meaning as in the Local Authorities' Traffic Orders (Exemptions for Disabled Persons) (England) Regulations 2000;

"disabled persons' vehicle" has the same meaning as in the Local Authorities' Traffic Orders (Exemptions for Disabled Persons) (England) Regulations 2000;

"goods" includes postal packets of any description, cash or other valuable securities;

"goods vehicle" means a motor vehicle which is constructed or adapted for the carriage of goods of any description and which does not exceed 3.5 tonnes gross laden weight;

"passenger vehicle" means a motor vehicle (other than a motor cycle or invalid carriage) constructed solely for the carriage of passengers and their effects and

adapted to carry not more than twelve passengers exclusive of the driver, and not drawing a trailer;

"postal packets" has the same meaning as in Section 125 of the Postal Services Act 2000;

"prescribed days and hours" means on the days and between those hours stated in the Schedules of this Order;

"restricted road" means a road which is subject to parking and waiting restrictions;

"road" means a highway and any other road to which the public has access;

"school vehicle or community transport vehicle" means a vehicle belonging to the Council or to a company who is under contract to the Council to provide transport services within the borough of Milton Keynes;

"statutory undertaker" has the same meaning as in Section 329 of the Highways Act 1980;

"telecommunications apparatus" has the same meaning as in the Telecommunications Act 1984;

"traffic sign" means a sign of any size, colour and type prescribed or authorised under, or having effect as though prescribed or authorised under, Section 64 of the Act of 1984.

3. Any reference in this Order to any enactment shall be construed as a reference to that enactment as amended by any subsequent enactment.
4. The plans annexed to this Order identify the areas subject to this Order, provided that where there is any inconsistency between the plans and the Schedules it is the wording of the Schedules which shall prevail.
5. Without prejudice to the validity of anything done or to any liability incurred in respect of any act or omission before the coming into effect of this Order any provisions of any Orders mentioned in Schedule 5 to this Order are hereby revoked to the extent stated in that Schedule.

## **PART 2**

### **PROHIBITION AND RESTRICTION OF WAITING**

6. No person shall except with the permission or under the direction of a police officer in uniform, a traffic warden or a Civil Enforcement Officer (CEO) cause or permit any vehicle to wait at any time in any of the lengths of roads specified in Schedule 1 hereto.

7. Nothing in Article 6. above shall render it a contravention of this Order to cause or permit any vehicle to wait in any of the lengths of roads specified in Schedule 1 for so long as may be necessary:-
- (1) to enable a person to board or alight from the vehicle;
  - (2) if the vehicle is a bus or passenger vehicle;
  - (3) If the vehicle is a goods vehicle and is delivering and /or collecting.
  - (4) when the person in control of the vehicle is required by law to stop or is obliged to stop in order to avoid an accident or is prevented from proceeding by circumstances outside his control;
  - (5) for a vehicle to wait whilst any gate or other barrier at the entrance to premises to which the vehicle requires access or from which it has emerged is being opened or closed, if it is not reasonably practicable for the vehicle to wait outside otherwise than in a length of road specified in Schedule 1A to this Order while such gate or other barrier is being opened or closed;
  - (6) to enable the vehicle if it cannot reasonably be used for such purpose in any other road to be used in connection with any of the following:-
    - a) building, industrial or demolition operations;
    - b) the removal of any obstruction to traffic;
    - c) the laying, erection or repair of any sewer, main, pipe or apparatus for the supply of gas, water, electricity or any telecommunication system defined by the Telecommunications Act 1984;
    - d) use in the service of any undertaker, the Environment Agency or any public authority in pursuance of statutory powers or duties;
    - e) any wedding or funeral;
    - f) use for police, military, fire brigade or ambulance purposes;
    - g) use for the purpose of delivering or collecting postal packets as defined by section 125 of the Postal Services Act 2000;
    - h) the vehicle being specially constructed or adapted for the delivery or collection of money or valuable securities to be used for those purposes in relation to premises in the vicinity;
    - i) to carry out the removal of furniture or household effects to or from a shop, office, depository or dwelling house in the vicinity.
8. In accordance with the Local Authorities' Traffic Orders (Exemptions for Disabled Persons) (England) Regulations 2000, nothing in Article 6 shall render it a contravention of this Order to cause or permit a disabled person's vehicle which displays a disabled person's badge and parking disc in the relevant position in

accordance with Articles 9. and 10. hereof to wait for a period not exceeding 3 hours in any of the lengths of road specified in Schedule 1 hereto (provided the period of exempted waiting does not begin less than one hour after a previous period of exempted waiting by the same vehicle in the same length of road on the same day.

9. For the purposes of this Order a vehicle shall be regarded as displaying a disabled person's badge in the relevant position under the Disabled Persons (Badges for Motor Vehicles) (England) Regulations 2000 if:-
  - (1) the badge is exhibited on the dashboard or fascia of the vehicle so that the front of the badge is clearly legible from the outside of the vehicle; or
  - (2) where the vehicle is not fitted with a dashboard or fascia, the badge is exhibited in a conspicuous position on the vehicle so that the front of the badge is clearly legible from the outside of the vehicle.
10. For the purposes of this Order a vehicle shall be regarded as displaying a parking disc in the relevant position under the Local Authorities' Traffic Orders (Exemptions for Disabled Persons) (England) Regulations 2000 if:-
  - (1) the disc is exhibited on the dashboard or fascia of the vehicle so that when marked to show the quarter hour period during which a period of waiting began, that period is clearly legible from the outside of the vehicle; or
  - (2) where the vehicle does not have a dashboard or fascia, the disc is exhibited in a conspicuous position on the vehicle so that, when marked to show the quarter hour period during which a period of waiting began, that period is clearly legible from the outside of the vehicle.
11. No person shall except with the permission or under the direction of a police officer in uniform, a traffic warden or a Civil Enforcement Officer (CEO) cause or permit any vehicle to wait during the prescribed days and hours in any of the lengths of roads specified in Schedule 2 hereto.
12. Nothing in Article 11 above shall render it a contravention of this Order to cause or permit any vehicle to wait in any of the lengths of roads specified in Schedule 2 for so long as may be necessary:-
  - (1) if the vehicle is a bus or passenger vehicle;
  - (2) when the person in control of the vehicle is required by law to stop or is obliged to stop in order to avoid an accident or is prevented from proceeding by circumstances outside his control;
  - (3) for a vehicle to wait whilst any gate or other barrier at the entrance to premises to which the vehicle requires access or from which it has emerged is being opened or closed, if it is not reasonably practicable for the vehicle to

wait outside otherwise than in a length of road specified in Schedule 2 to this Order while such gate or other barrier is being opened or closed;

- (4) to enable the vehicle if it cannot reasonably be used for such purpose in any other road to be used in connection with any of the following:-
- a) building, industrial or demolition operations;
  - b) the removal of any obstruction to traffic;
  - c) the laying, erection or repair of any sewer, main, pipe or apparatus for the supply of gas, water, electricity or any telecommunication system defined by the Telecommunications Act 1984;
  - d) use in the service of any undertaker, the Environment Agency or any public authority in pursuance of statutory powers or duties;
  - e) any wedding or funeral;
  - f) use for police, military, fire brigade or ambulance purposes;
  - g) use for the purpose of delivering or collecting postal packets as defined by section 125 of the Postal Services Act 2000;
  - h) the vehicle being specially constructed or adapted for the delivery or collection of money or valuable securities to be used for those purposes in relation to premises in the vicinity;
  - i) to carry out the removal of furniture or household effects to or from a shop, office, depository or dwelling house in the vicinity.
13. In accordance with the Local Authorities' Traffic Orders (Exemptions for Disabled Persons) (England) Regulations 2000, nothing in Article 11 shall render it a contravention of this Order to cause or permit a disabled person's vehicle which displays a disabled person's badge in the relevant position in accordance with Article 14 hereof to wait in any of the lengths of road specified in Schedule 2 hereto.
14. For the purposes of this Order a vehicle shall be regarded as displaying a disabled person's badge in the relevant position under the Disabled Persons (Badges for Motor Vehicles) (England) Regulations 2000 if:-
- (1) the badge is exhibited on the dashboard or fascia of the vehicle so that the front of the badge is clearly legible from the outside of the vehicle; or
  - (2) where the vehicle is not fitted with a dashboard or fascia, the badge is exhibited in a conspicuous position on the vehicle so that the front of the badge is clearly legible from the outside of the vehicle.

## **PART 3**

### **PROHIBITION OF LOADING AND UNLOADING**

15. No person shall except with the permission or under the direction of a police officer in uniform, a traffic warden or CEO cause or permit any vehicle to load or unload at any time during the prescribed days and hours in the lengths of road specified in Schedules 3 and 4 hereto.

### **ENFORCEMENT OF RESTRICTIONS**

16. The Council shall, on or in the vicinity of a restricted road:
- (1) Highlight each restricted area with notices, signs and road surface markings in accordance with the Traffic Signs Regulations and General Directions Act 2002;
  - (2) Maintain and from time to time alter the said notices, signs and road-surface markings;
  - (3) Carry out such other work as is reasonably required for the purpose of the satisfactory operation of a restricted road.
17. The Council shall appoint Civil Enforcement Officers whose duty it shall be to patrol and enforce the waiting and parking restrictions imposed by the Articles of this Order.

### **SCHEDULE 1**

#### **NO WAITING AT ANY TIME 24 HOURS OF EVERY DAY**

#### **MARIGOLD PLACE, CONNIBURROW – CENTRAL RESERVATION SOUTH-EAST END – EAST-SIDE**

- NW1 From a point approximately 3.6 metres north-west of its junction with Conniburrow Boulevard for a distance of approximately 19.3 metres in a south-east, then south-west and then north-westerly direction following the kerb line around the end of the central reservation

#### **MARIGOLD PLACE, CONNIBURROW – SOUTH-EAST SIDE**

- NW2 From a point approximately 8.8 metres north-west of its junction with Conniburrow Boulevard for a distance of approximately 23.5 metres in a generally south east and then north easterly direction, following the kerb line onto Conniburrow Boulevard

**STONECROP PLACE, CONNIBURROW – NORTH-WEST SIDE**

NW3 From a point approximately 8.3 metres southeast of its junction with Conniburrow Boulevard for a distance of approximately 19.3 metres in a generally north west and then south westerly direction, following the kerb line onto Conniburrow Boulevard

**STONECROP PLACE, CONNIBURROW – CENTRAL RESERVATION - NORTH-WEST END – WEST-SIDE**

NW4 From a point approximately 3.2 metres south-east of its junction with Conniburrow Boulevard for a distance of approximately 17.5 metres in a north-west, then north-east and then south-easterly direction following the kerb line around the end of the central reservation

**STONECROP PLACE, CONNIBURROW – NORTH-EAST SIDE**

NW5 From a point approximately 5.3 metres southeast of its junction with Conniburrow Boulevard for a distance of approximately 18.2 metres in a generally north-west and then north easterly direction, following the kerb line onto Conniburrow Boulevard

**MARJORAM PLACE, CONNIBURROW – SOUTH-WEST SIDE**

NW6 From a point approximately 11.9 metres north-west of its junction with Conniburrow Boulevard for a distance of approximately 30.8 metres in a generally south east and then south westerly direction, following the kerb line onto Conniburrow Boulevard

**MARJORAM PLACE, CONNIBURROW – CENTRAL RESERVATION - SOUTH-EAST END – EAST-SIDE**

NW7 From a point approximately 3.5 metres north-west of its junction with Conniburrow Boulevard for a distance of approximately 18.6 metres in a south-east, then south-west and then north-westerly direction following the kerb line around the end of the central reservation

**MARJORAM PLACE, CONNIBURROW – SOUTH-EAST SIDE**

NW8 From a point approximately 10.5 metres north-west of its junction with Conniburrow Boulevard for a distance of approximately 20.9 metres in a generally southeast and then north easterly direction, following the kerb line onto Conniburrow Boulevard

**SPEEDWELL PLACE, CONNIBURROW – NORTH-WEST SIDE**

NW9 From a point approximately 10.3 metres south-east of its junction with Conniburrow Boulevard for a distance of approximately 21.8 metres in a generally north west and then south westerly direction, following the kerb line onto Conniburrow Boulevard

**SPEEDWELL PLACE, CONNIBURROW – CENTRAL RESERVATION - NORTH-WEST END – WEST-SIDE**

NW10 From a point approximately 3.7 metres south-east of its junction with Conniburrow Boulevard for a distance of approximately 18.8 metres in a north-west, then north-east and then south-easterly direction following the kerb line around the end of the central reservation

**SPEEDWELL PLACE, CONNIBURROW – SOUTH-WEST SIDE**

NW11 From a point approximately 15.3 metres north-west of its junction with Ramsons Avenue for a distance of approximately 26.4 metres in a generally south east and then south westerly direction, following the kerb line onto Ramsons Avenue

**SPEEDWELL PLACE, CONNIBURROW – CENTRAL RESERVATION - SOUTH-EAST END – EAST-SIDE**

NW12 From a point approximately 3.5 metres north-west of its junction with Ramsons Avenue for a distance of approximately 18.3 metres in a south-east, then south-west and then north-westerly direction following the kerb line around the end of the central reservation

**BRAMBLE AVENUE, CONNIBURROW - CENTRAL RESERVATION - SOUTH-EAST, SOUTH-WEST AND NORTH-WEST SIDE**

NW13 From a point approximately 6 metres south-west of its junction with Bryony Place for a distance of approximately 25 metres in a north-easterly then south-easterly and then south-westerly direction.

NW14 From a point approximately 6 metres north-east of its junction with Bryony Place for a distance of approximately 25 metres in a south-westerly then south-easterly and then north-easterly direction.

**BRAMBLE AVENUE AND BRYONY PLACE, CONNIBURROW – SOUTH-EAST AND SOUTH-WEST SIDE**

NW15 From a point on Bramble Avenue approximately 6 metres south-west of its junction with Bryony Place for a distance of approximately 21 metres in a north-easterly then south-easterly direction onto Bryony Place

**BRAMBLE AVENUE AND BRYONY PLACE, CONNIBURROW – SOUTH-EAST AND NORTH-EAST SIDE**

NW16 From a point on Bramble Avenue approximately 6 metres south-west of its junction with Bryony Place for a distance of approximately 23 metres in a north-easterly then south-easterly direction onto Bryony Place.

**BRYONY PLACE, CONNIBURROW - CENTRAL RESERVATION - NORTH-EAST, SOUTH-EAST AND SOUTH-WEST SIDE**

NW17 From a point approximately 6 metres south-east of its junction with Bramble Avenue for a distance of approximately 24 metres in a north-westerly then north-easterly, then south-easterly direction.

**BRYONY PLACE, CONNIBURROW - CENTRAL RESERVATION - NORTH-EAST, NORTH-WEST AND SOUTH-WEST SIDE**

NW18 From a point approximately 6 metres north-west of its junction with Conniburrow Boulevard for a distance of approximately 25 metres in a south-easterly then north-easterly, then north-westerly direction.

**CONNIBURROW BOULEVARD, CONNIBURROW – THE NORTH-WEST VEHICULAR ACCESSWAY – SOUTH-EAST, SOUTH-WEST AND NORTH-WEST SIDE**

NW19 From a point approximately 11 metres south-west of its junction with Germander Place for a distance of approximately 27 metres in a north-easterly then south-easterly, then south-westerly direction.

**GERMANDER PLACE, CONNIBURROW – CENTRAL RESERVATION – NORTH-EAST, NORTH-WEST AND SOUTH-WEST SIDE**

NW20 From a point approximately 6 metres north-west of its junction with Conniburrow Boulevard for a distance of approximately 24 metres in a south-easterly then north-easterly, then north-westerly direction.



## **SCHEDULE 2**

**NO WAITING  
BETWEEN THE HOURS OF 8.00 AM AND 9.30 AM  
AND 2.30 PM AND 3.30 PM - MONDAY TO FRIDAY**

### **BRAMBLE AVENUE AND BRYONY PLACE, CONNIBURROW – NORTH-WEST SIDE**

NW21 From a point on Bramble Avenue approximately 8 metres south-west of its junction with Bryony Place for a distance of approximately 30 metres in a north-easterly direction onto Bryony Place.

### **BRAMBLE AVENUE AND BRYONY PLACE, CONNIBURROW – NORTH-EAST SIDE**

NW22 From a point on Bramble Avenue approximately 12 metres north-east of its junction with Bryony Place for a distance of approximately 31 metres in a south-westerly then north-westerly direction onto Bryony Place.

### **CONNIBURROW BOULEVARD, CONNIBURROW – THE NORTH-WEST VEHICULAR ACCESSWAY – SOUTH-EAST SIDE**

NW23 From a point approximately 22 metres south-west of its junction with Germander Place for a distance of approximately 15 metres in a south-westerly direction.

## **SCHEDULE 3**

**NO LOADING OR UNLOADING AT ANY TIME  
24 HOURS OF EVERY DAY**

### **BRAMBLE AVENUE, CONNIBURROW - CENTRAL RESERVATION - SOUTH-EAST, SOUTH-WEST AND NORTH-WEST SIDE**

NL1 From a point approximately 6 metres south-west of its junction with Bryony Place for a distance of approximately 25 metres in a north-easterly then south-easterly and then south-westerly direction.

NL2 From a point approximately 6 metres north-east of its junction with Bryony Place for a distance of approximately 25 metres in a south-westerly then south-easterly and then north-easterly direction.

### **BRAMBLE AVENUE AND BRYONY PLACE, CONNIBURROW – SOUTH-EAST AND SOUTH-WEST SIDE**

NL3 From a point on Bramble Avenue approximately 6 metres south-west of its junction with Bryony Place for a distance of approximately 21 metres in a north-easterly then south-easterly direction onto Bryony Place

### **BRAMBLE AVENUE AND BRYONY PLACE, CONNIBURROW – SOUTH-EAST AND NORTH-EAST SIDE**

NL4 From a point on Bramble Avenue approximately 6 metres south-west of its junction with Bryony Place for a distance of approximately 23 metres in a north-easterly then south-easterly direction onto Bryony Place.

**BRYONY PLACE, CONNIBURROW - CENTRAL RESERVATION - NORTH-EAST, SOUTH-EAST AND SOUTH-WEST SIDE**

NL5 From a point approximately 6 metres south-east of its junction with Bramble Avenue for a distance of approximately 24 metres in a north-westerly then north-easterly, then south-easterly direction.

**BRYONY PLACE, CONNIBURROW - CENTRAL RESERVATION - NORTH-EAST, NORTH-WEST AND SOUTH-WEST SIDE**

NL6 From a point approximately 6 metres north-west of its junction with Conniburrow Boulevard for a distance of approximately 25 metres in a south-easterly then north-easterly, then north-westerly direction.

**CONNIBURROW BOULEVARD, CONNIBURROW – THE NORTH-WEST VEHICULAR ACCESSWAY – SOUTH-EAST, SOUTH-WEST AND NORTH-WEST SIDE**

NL7 From a point approximately 11 metres south-west of its junction with Germander Place for a distance of approximately 27 metres in a north-easterly then south-easterly, then south-westerly direction.

**GERMANDER PLACE, CONNIBURROW – CENTRAL RESERVATION – NORTH-EAST, NORTH-WEST AND SOUTH-WEST SIDE**

NL8 From a point approximately 6 metres north-west of its junction with Conniburrow Boulevard for a distance of approximately 24 metres in a south-easterly then north-easterly, then north-westerly direction.

**SCHEDULE 4**

**NO LOADING OR UNLOADING  
BETWEEN THE HOURS OF 8.00 AM AND 9.30 AM  
AND 2.30 PM AND 3.30 PM - MONDAY TO FRIDAY**

**BRAMBLE AVENUE AND BRYONY PLACE, CONNIBURROW – NORTH-WEST SIDE**

NL9 From a point on Bramble Avenue approximately 8 metres south-west of its junction with Bryony Place for a distance of approximately 30 metres in a north-easterly direction onto Bryony Place.

**BRAMBLE AVENUE AND BRYONY PLACE, CONNIBURROW – NORTH-EAST SIDE**

NL10 From a point on Bramble Avenue approximately 12 metres north-east of its junction with Bryony Place for a distance of approximately 31 metres in a south-westerly then north-westerly direction onto Bryony Place.

**CONNIBURROW BOULEVARD, CONNIBURROW – THE NORTH-WEST VEHICULAR ACCESSWAY – SOUTH-EAST SIDE**

NL11 From a point approximately 22 metres south-west of its junction with Germander Place for a distance of approximately 15 metres in a south-westerly direction.

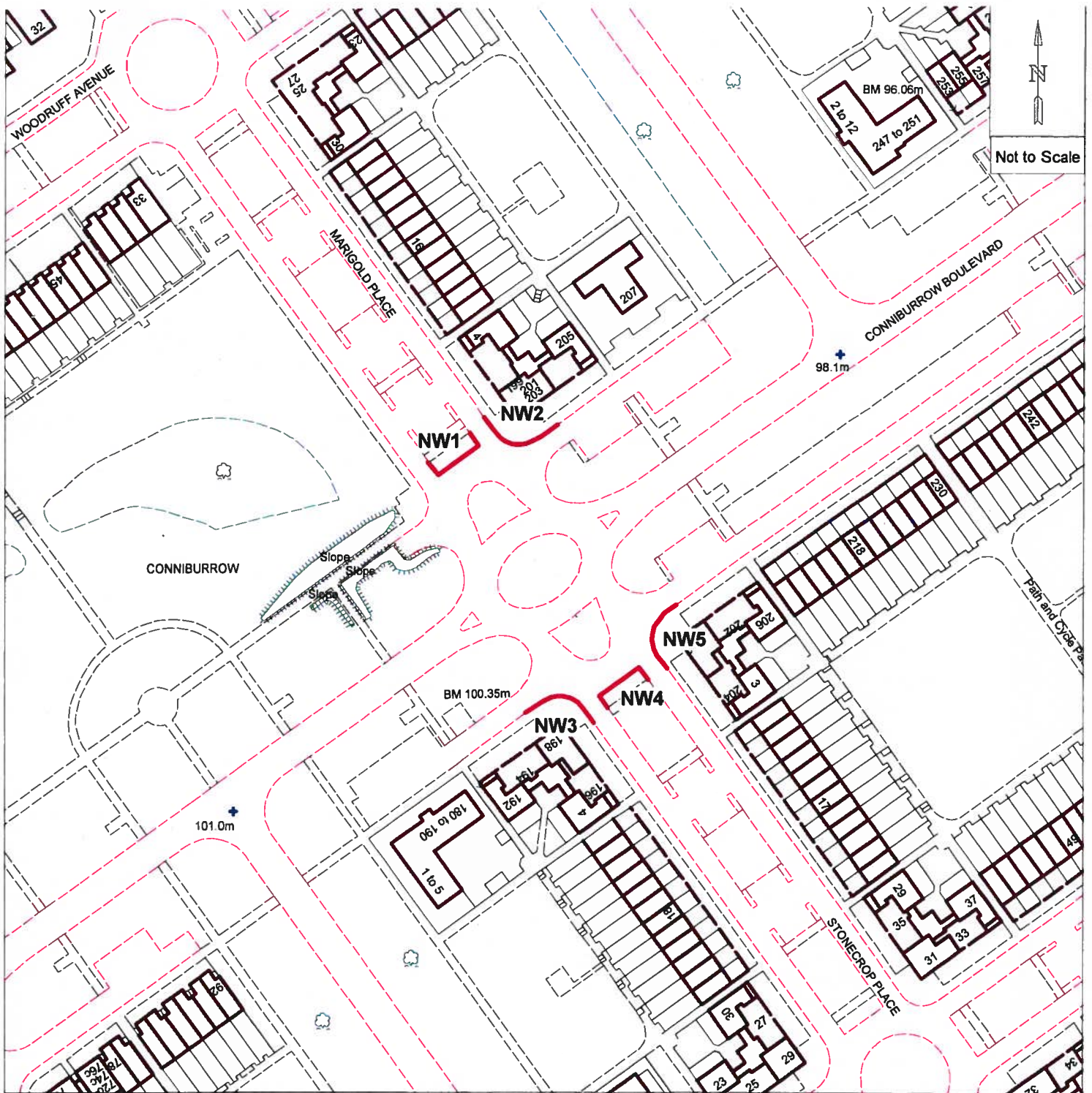

# **MAP FOR TRAFFIC REGULATION ORDER**

 No Waiting at Any Time

**NW1** TRO Reference Number

Map referred to in the Council of the Borough of Milton Keynes (Various Roads, Conniburrow) (Prohibition and Restriction of Waiting and Loading) Order 2013

Map 1

The Common Seal of the Council of the Borough of Milton Keynes was hereunto affixed in the presence of:



ACTING ASSISTANT DIRECTOR - LAW AND GOVERNANCE

**SEAL:**

21077





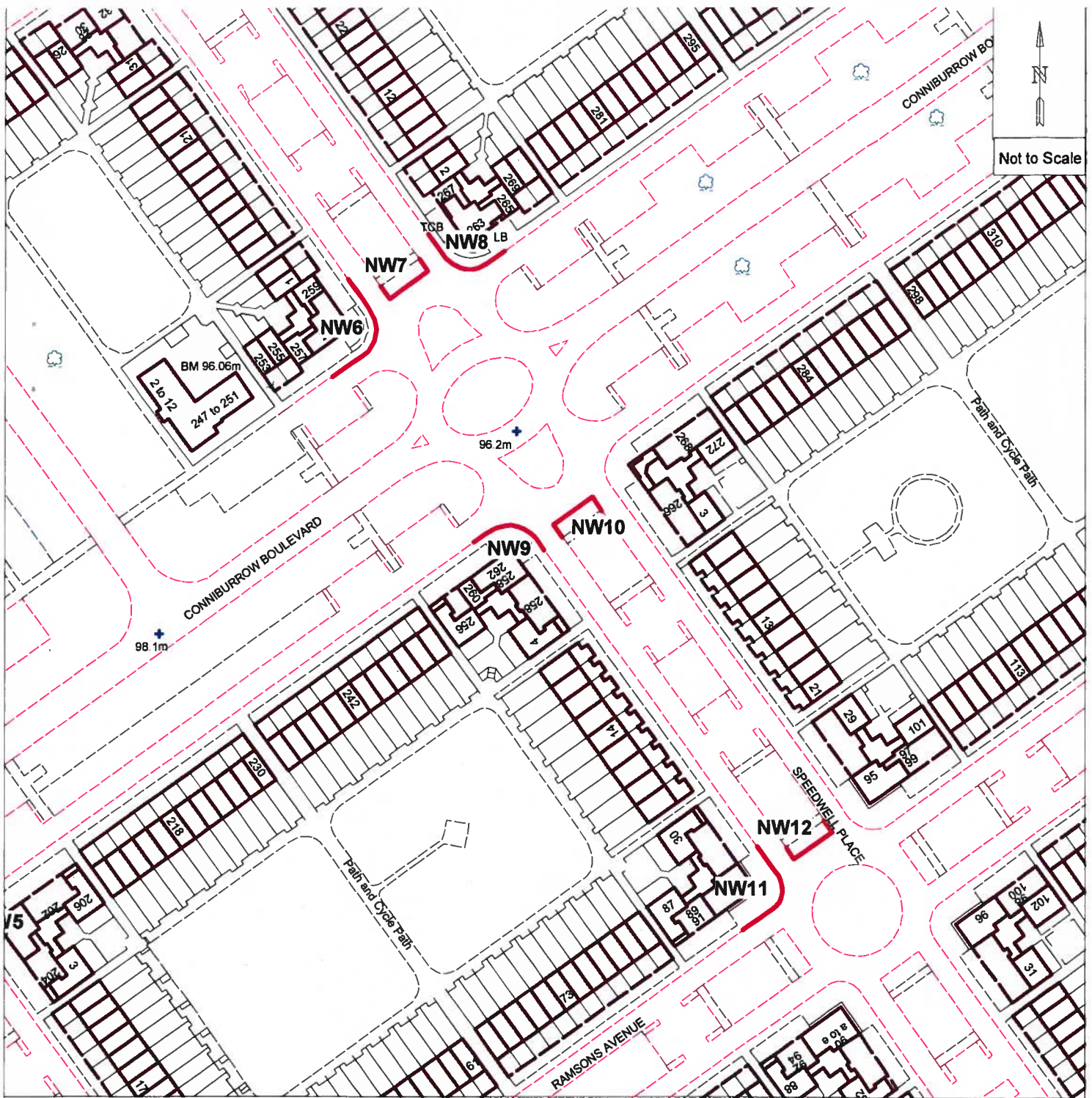

# **MAP FOR TRAFFIC REGULATION ORDER**



No Waiting at Any Time

NW6 TRO Reference Number

Map referred to in the Council of the Borough of Milton Keynes (Various Roads, Conniburrow) (Prohibition and Restriction of Waiting and Loading) Order 2013

Map 2

The Common Seal of the Council of the Borough of Milton Keynes was hereunto affixed in the presence of:

ACTING ASSISTANT DIRECTOR - LAW AND GOVERNANCE

SEAL:

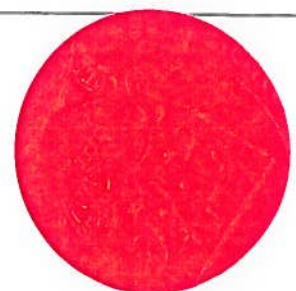

21077



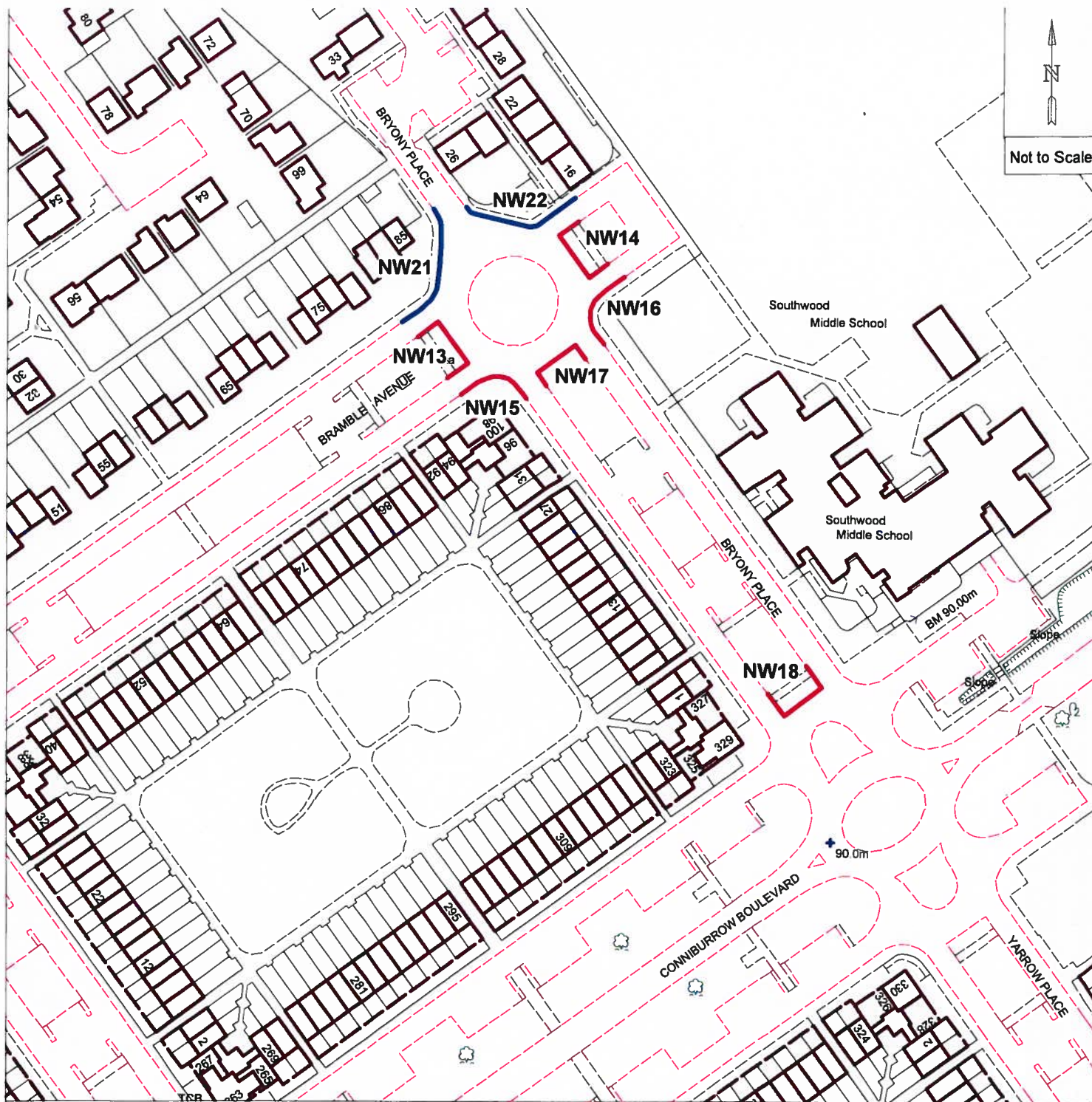

# **MAP FOR TRAFFIC REGULATION ORDER**

- No Waiting at Any Time
- No Waiting  
Monday to Friday  
8.00am-9.30am and 2.30pm-3.30pm

**NW13** TRO Reference Number

Map referred to in the Council of the Borough of Milton Keynes (Various Roads, Conniburrow) (Prohibition and Restriction of Waiting and Loading) Order 2013

Map 3

The Common Seal of the Council of the Borough of Milton Keynes was hereunto affixed in the presence of:

ACTING ASSISTANT DIRECTOR - LAW AND GOVERNANCE

**SEAL:**

21077



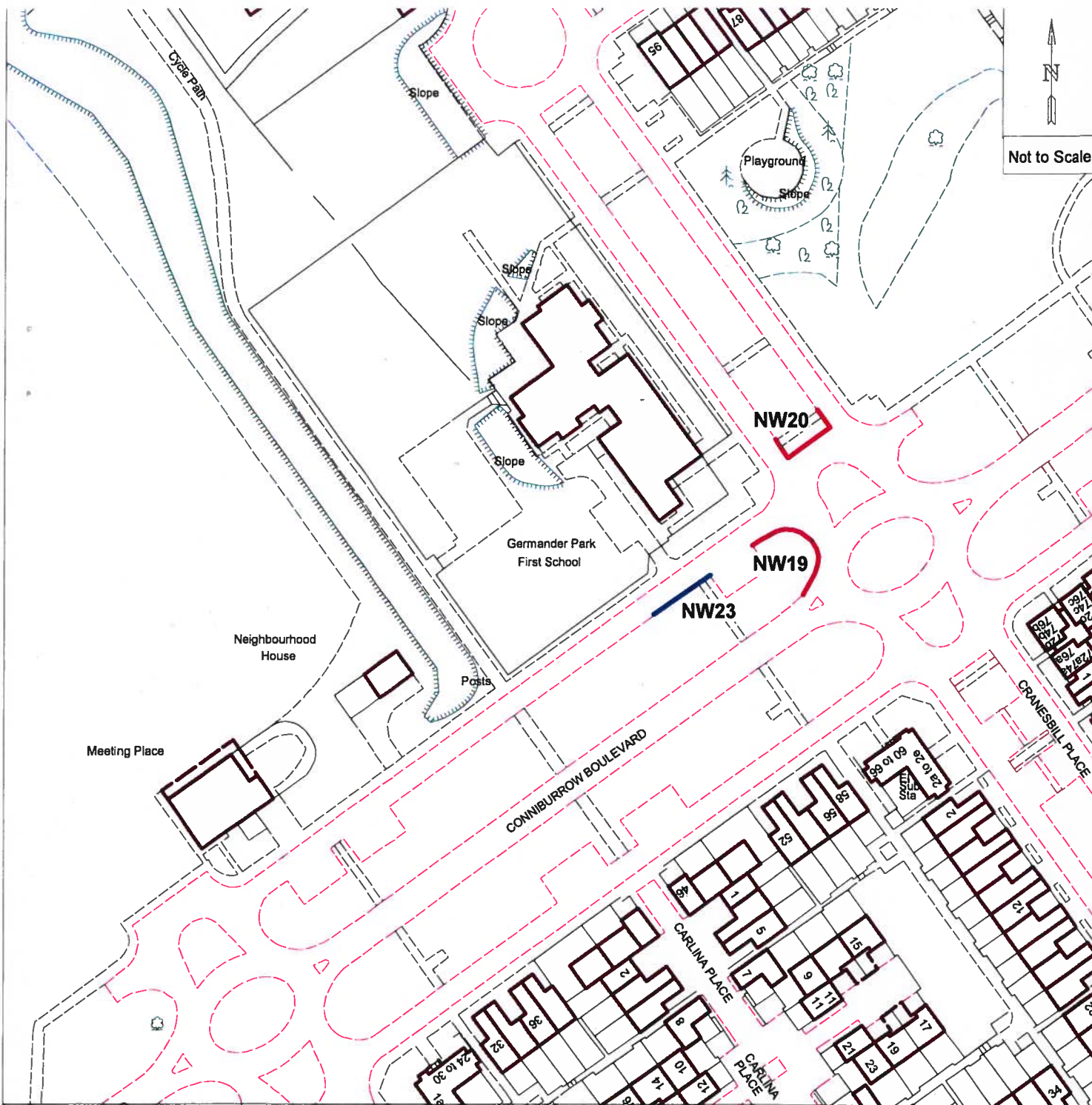

## MAP FOR TRAFFIC REGULATION ORDER

- No Waiting at Any Time
- No Waiting  
Monday to Friday  
8.00am-9.30am and 2.30pm-3.30pm

NW19 TRO Reference Number

Map referred to in the Council of the Borough of Milton Keynes (Various Roads, Conniburrow) (Prohibition and Restriction of Waiting and Loading) Order 2013

Map 4

The Common Seal of the Council of the Borough of Milton Keynes was hereunto affixed in the presence of:

*[Signature]*

ACTING ASSISTANT DIRECTOR - LAW AND GOVERNANCE

SEAL:

21077



Not to Scale



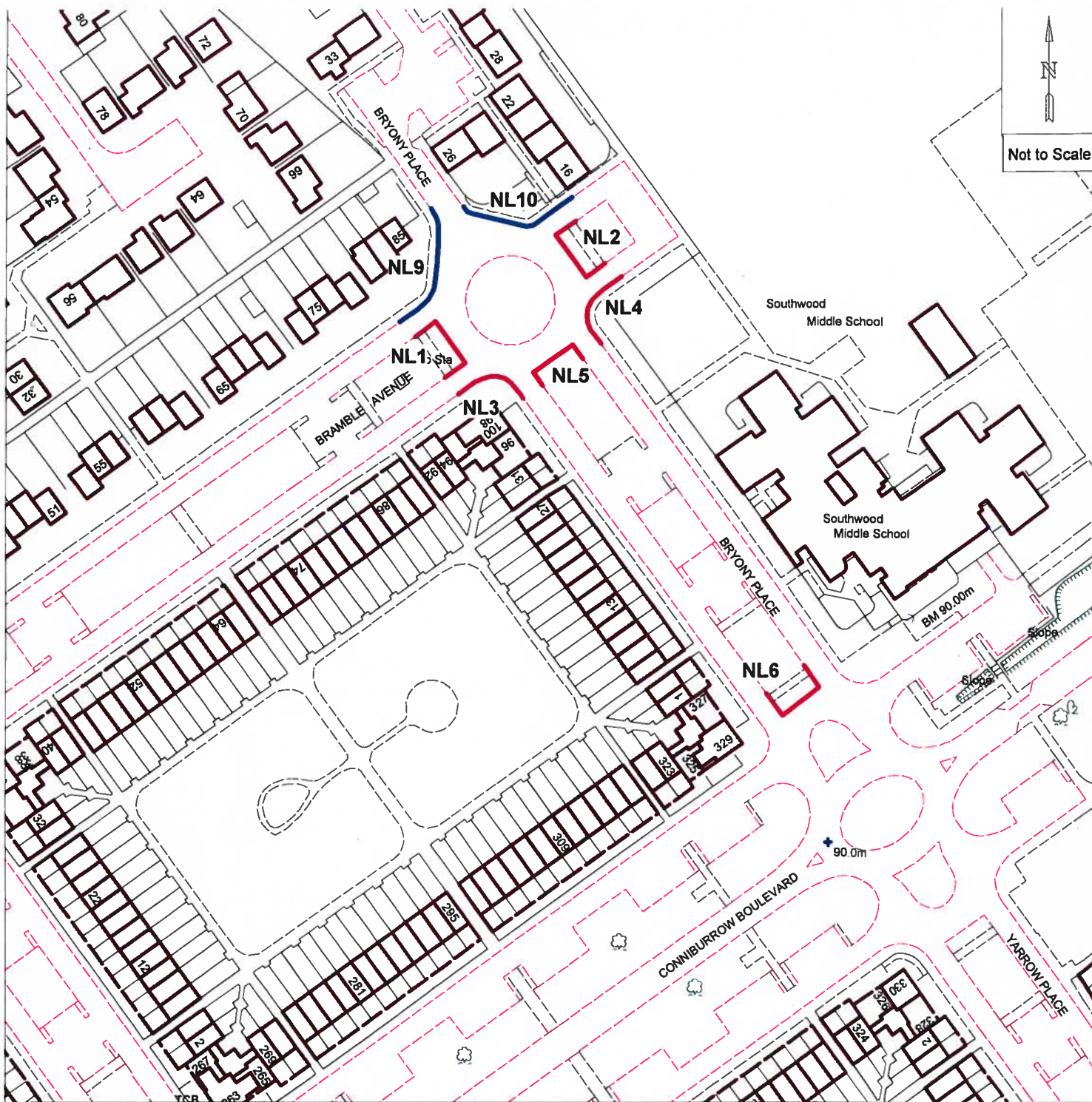

# **MAP FOR TRAFFIC REGULATION ORDER**

- No Loading or Unloading
- No Loading or Unloading  
Monday to Friday  
8.00am-9.30am and 2.30pm-3.30pm

**NL1** TRO Reference Number

Map referred to in the Council of the Borough of Milton Keynes (Various Roads, Conniburrow) (Prohibition and Restriction of Waiting and Loading) Order 2013

Map 5

The Common Seal of the Council of the Borough of Milton Keynes was hereunto affixed in the presence of:

*[Signature]*

ACTING ASSISTANT DIRECTOR - LAW AND GOVERNANCE

**SEAL:**

21077



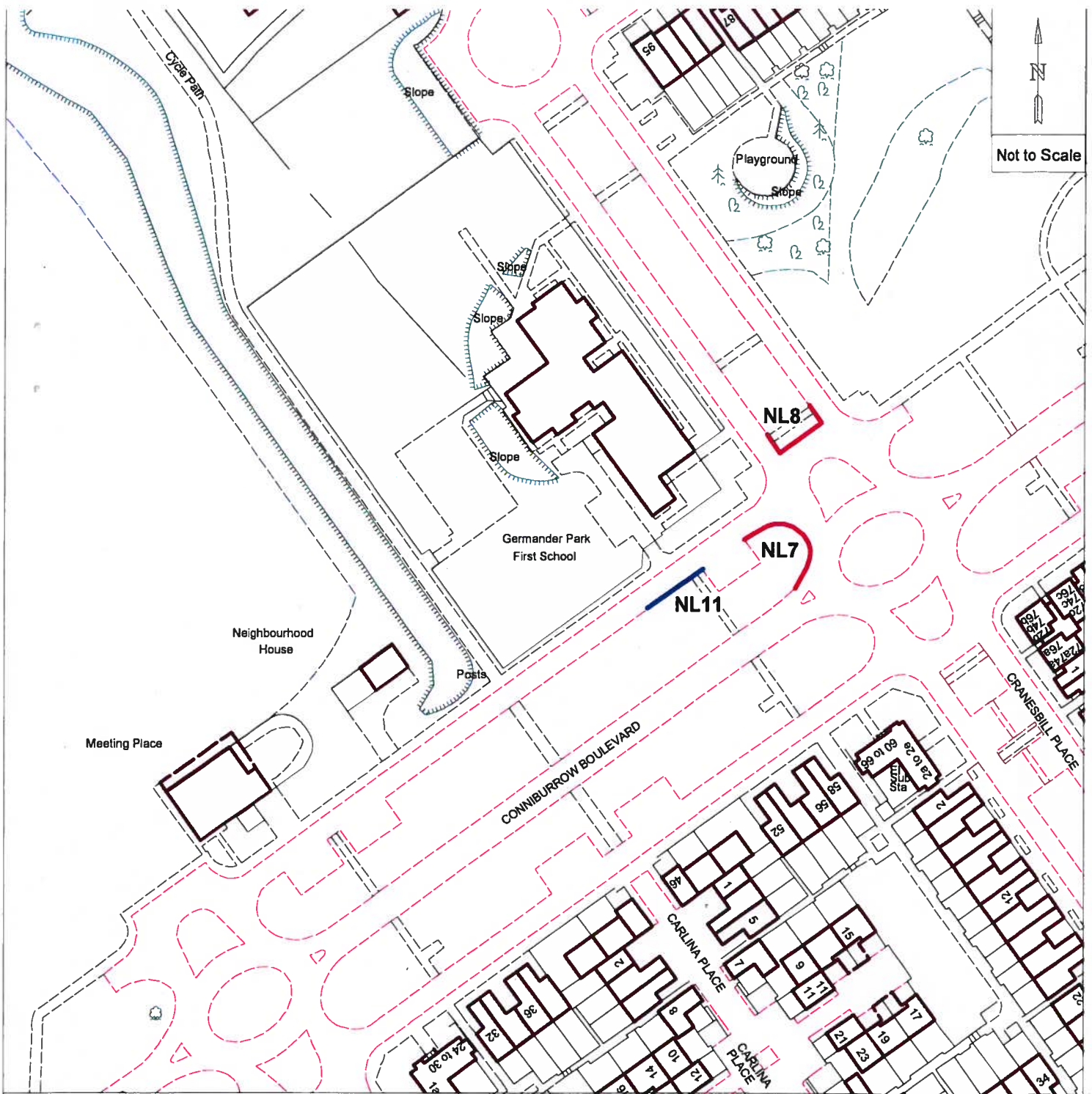

# **MAP FOR TRAFFIC REGULATION ORDER**

- No Loading or Unloading
- No Loading or Unloading  
Monday to Friday  
8.00am-9.30am and 2.30pm-3.30pm

**NL7** TRO Reference Number

Map referred to in the Council of the Borough of Milton Keynes (Various Roads, Conniburrow) (Prohibition and Restriction of Waiting and Loading) Order 2013

Map 6

The Common Seal of the Council of the Borough of Milton Keynes was hereunto affixed in the presence of:

*[Signature]*

ACTING ASSISTANT DIRECTOR - LAW AND GOVERNANCE

SEAL:

21077





**SCHEDULE 5**

**REVOCATIONS**

The following Order **IS HEREBY REVOKED** in its entirety:-

**The Council of the Borough of Milton Keynes (Various Roads, Conniburrow)  
(Prohibition of Waiting) Order 2009**

**THE COMMON SEAL** of the **COUNCIL OF THE  
BOROUGH OF MILTON KEYNES** was hereunto

affixed this 20<sup>th</sup> day of February 2013

in the presence of:



.....  
**ACTING ASSISTANT DIRECTOR – LAW AND GOVERNANCE**

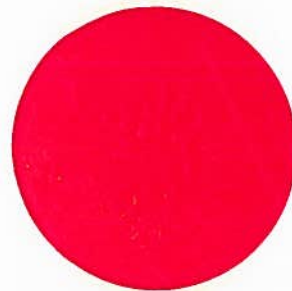

21077